

# Kit 1420

**CHEVROLET Aveo**, 4-dr Sedan, 06–  
**CHEVROLET Lova**, 4-dr Sedan, 06–  
**DAEWOO Gentra**, 4-dr Sedan, 06–  
**DAEWOO Kalos**, 4-dr Sedan, 06–  
**HOLDEN Barina**, 4-dr Sedan, 06–  
**PONTIAC G3**, 4-dr Sedan, 06–  
**PONTIAC Wave**, 4-dr Sedan, 06–

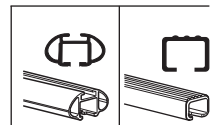

**Max.  
75kg**  
**Max.  
165 lbs**

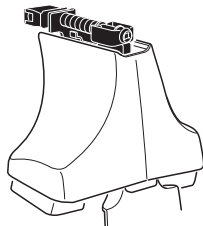
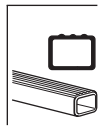
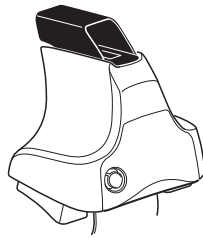
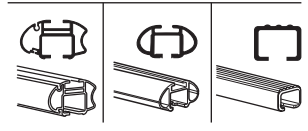
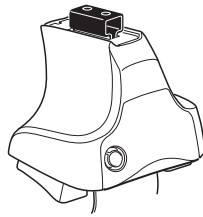

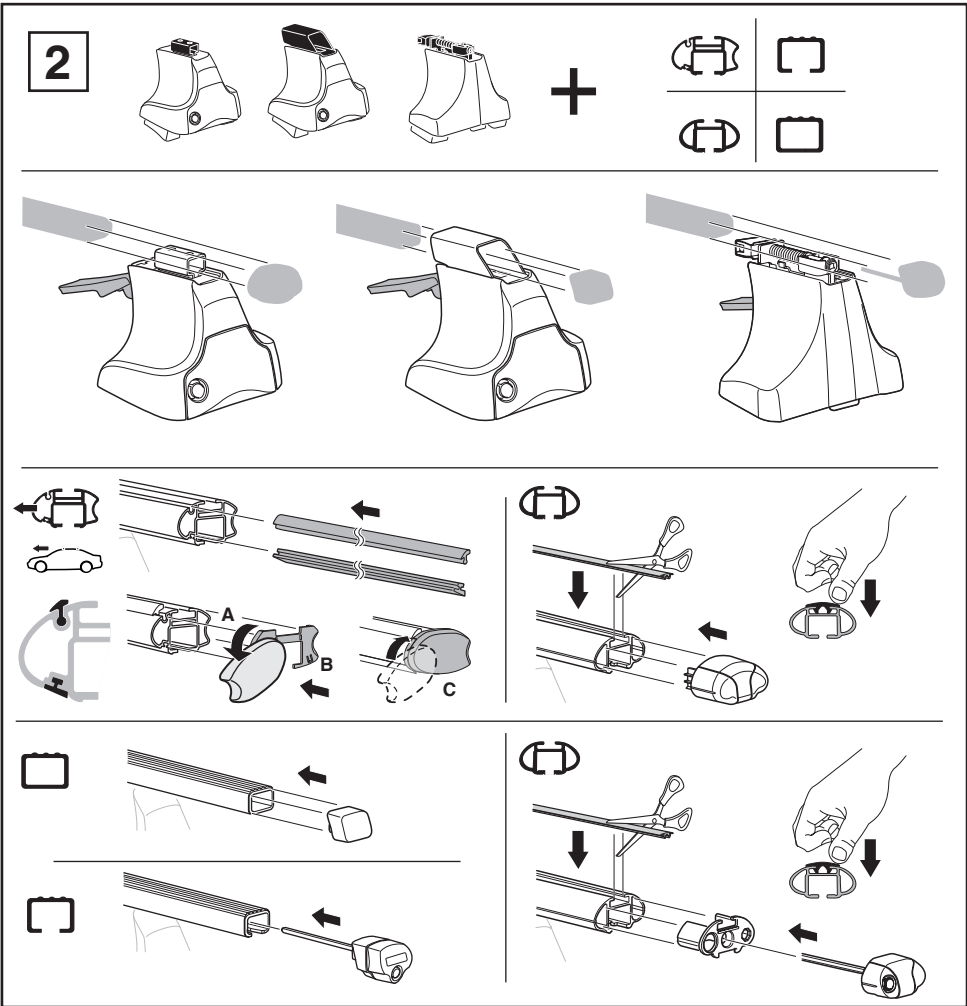
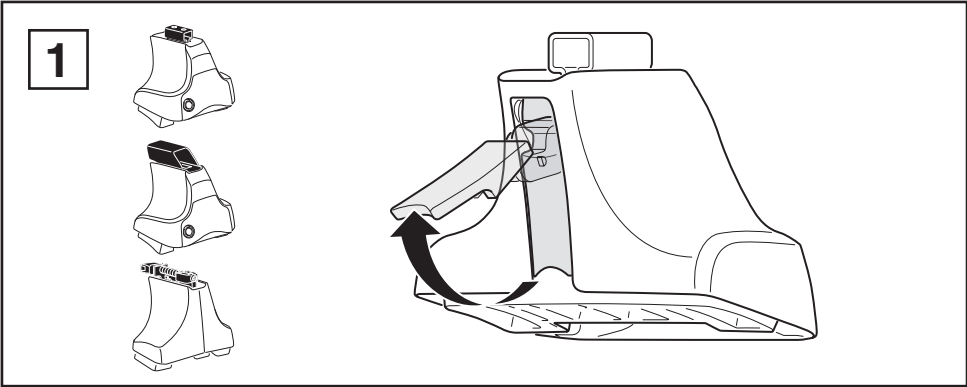
**Kit**

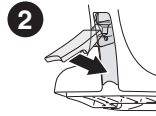
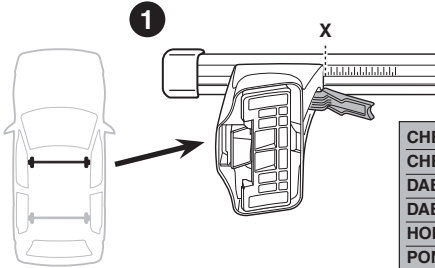
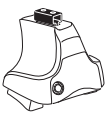

**3**

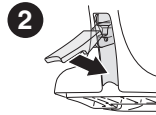
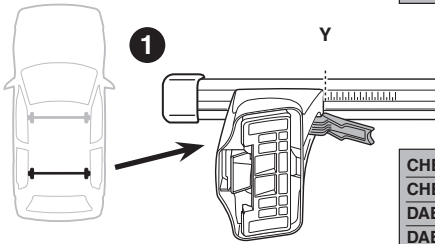

	X
CHEVROLET Aveo, 4-dr Sedan, 06-	28
CHEVROLET Lova, 4-dr Sedan, 06-	28
DAEWOO Gentra, 4-dr Sedan, 06-	28
DAEWOO Kalos, 4-dr Sedan, 06-	28
HOLDEN Barina, 4-dr Sedan, 06-	28
PONTIAC G3, 4-dr Sedan, 06-	28
PONTIAC Wave, 4-dr Sedan, 06-	28



	Y
CHEVROLET Aveo, 4-dr Sedan, 06-	22
CHEVROLET Lova, 4-dr Sedan, 06-	22
DAEWOO Gentra, 4-dr Sedan, 06-	22
DAEWOO Kalos, 4-dr Sedan, 06-	22
HOLDEN Barina, 4-dr Sedan, 06-	22
PONTIAC G3, 4-dr Sedan, 06-	22
PONTIAC Wave, 4-dr Sedan, 06-	22

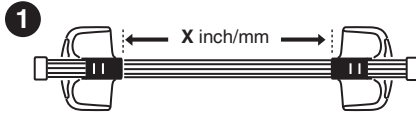

	X inch	X mm
CHEVROLET Aveo, 4-dr Sedan, 06-	36 <sup>5</sup> / <sub>8</sub> "	931 mm
CHEVROLET Lova, 4-dr Sedan, 06-	36 <sup>5</sup> / <sub>8</sub> "	931 mm
DAEWOO Gentra, 4-dr Sedan, 06-	36 <sup>5</sup> / <sub>8</sub> "	931 mm
DAEWOO Kalos, 4-dr Sedan, 06-	36 <sup>5</sup> / <sub>8</sub> "	931 mm
HOLDEN Barina, 4-dr Sedan, 06-	36 <sup>5</sup> / <sub>8</sub> "	931 mm
PONTIAC G3, 4-dr Sedan, 06-	36 <sup>5</sup> / <sub>8</sub> "	931 mm
PONTIAC Wave, 4-dr Sedan, 06-	36 <sup>5</sup> / <sub>8</sub> "	931 mm

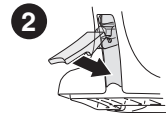
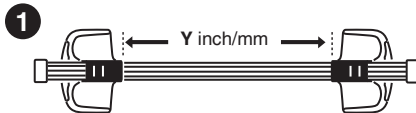
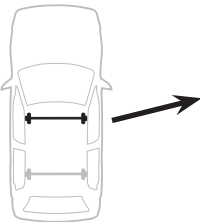

	Y inch	Y mm
CHEVROLET Aveo, 4-dr Sedan, 06-	34 <sup>1</sup> / <sub>4</sub> "	871 mm
CHEVROLET Lova, 4-dr Sedan, 06-	34 <sup>1</sup> / <sub>4</sub> "	871 mm
DAEWOO Gentra, 4-dr Sedan, 06-	34 <sup>1</sup> / <sub>4</sub> "	871 mm
DAEWOO Kalos, 4-dr Sedan, 06-	34 <sup>1</sup> / <sub>4</sub> "	871 mm
HOLDEN Barina, 4-dr Sedan, 06-	34 <sup>1</sup> / <sub>4</sub> "	871 mm
PONTIAC G3, 4-dr Sedan, 06-	34 <sup>1</sup> / <sub>4</sub> "	871 mm
PONTIAC Wave, 4-dr Sedan, 06-	34 <sup>1</sup> / <sub>4</sub> "	871 mm

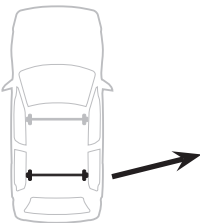

**4**

CHEVROLET Aveo, 4-dr Sedan, 06-  
CHEVROLET Lova, 4-dr Sedan, 06-  
DAEWOO Genra, 4-dr Sedan, 06-  
DAEWOO Kalos, 4-dr Sedan, 06-  
HOLDEN Barina, 4-dr Sedan, 06-  
PONTIAC G3, 4-dr Sedan, 06-  
PONTIAC Wave, 4-dr Sedan, 06-

179



784



181



784



258



368



258



368

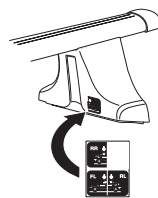
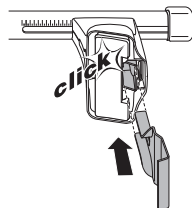
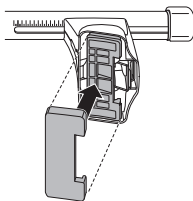
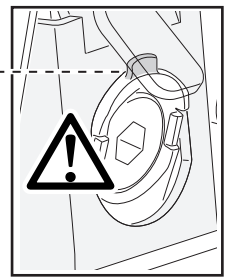
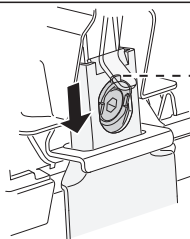
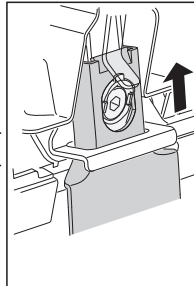
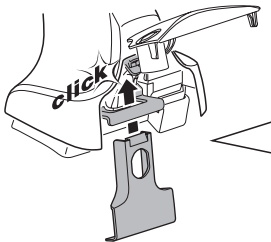
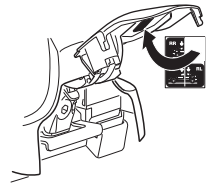
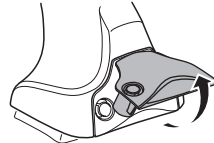
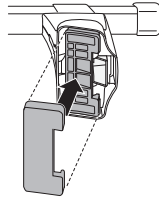
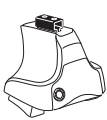

5

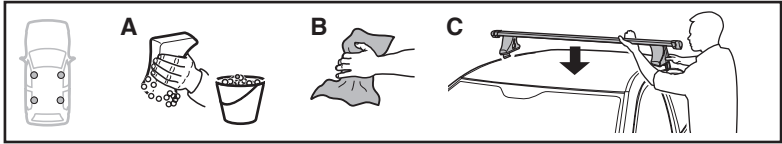

	X mm	Y mm	X inch	Y inch
CHEVROLET Aveo, 4-dr Sedan, 06-	250 mm	700 mm	9 <sup>7</sup> / <sub>8</sub> "	27 <sup>1</sup> / <sub>2</sub> "
CHEVROLET Lova, 4-dr Sedan, 06-	250 mm	700 mm	9 <sup>7</sup> / <sub>8</sub> "	27 <sup>1</sup> / <sub>2</sub> "
DAEWOO Gentra, 4-dr Sedan, 06-	250 mm	700 mm	9 <sup>7</sup> / <sub>8</sub> "	27 <sup>1</sup> / <sub>2</sub> "
DAEWOO Kalos, 4-dr Sedan, 06-	250 mm	700 mm	9 <sup>7</sup> / <sub>8</sub> "	27 <sup>1</sup> / <sub>2</sub> "
HOLDEN Barina, 4-dr Sedan, 06-	250 mm	700 mm	9 <sup>7</sup> / <sub>8</sub> "	27 <sup>1</sup> / <sub>2</sub> "
PONTIAC G3, 4-dr Sedan, 06-	250 mm	700 mm	9 <sup>7</sup> / <sub>8</sub> "	27 <sup>1</sup> / <sub>2</sub> "
PONTIAC Wave, 4-dr Sedan, 06-	250 mm	700 mm	9 <sup>7</sup> / <sub>8</sub> "	27 <sup>1</sup> / <sub>2</sub> "

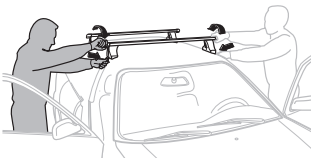
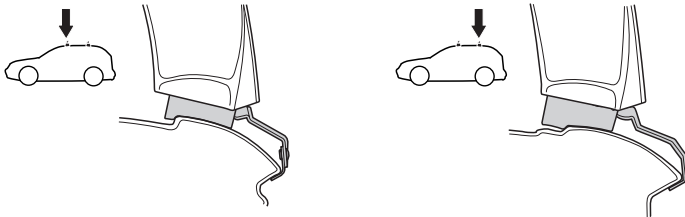
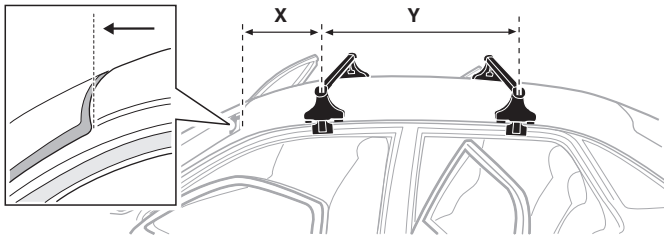

GB/US

Tighten alternately

D

Die Schrauben abwechselnd anziehen

F

Serrer alternativement chaque côté

NL

Afwisselend aan de linker- en de rechterkant aandraaien

I

Alternare il serraggio delle viti

E

Serrare alternativamente

PT

Aperte alternadamente

S

Dra åt växelvis

FIN

Kierrä vuorotellen

EST

Pinguldage vaheldumisi

LAT

Pielveciēt pamīšus

LIT

Užsukinėkite pakaitomis

PL

Śruby dokręcaj naprzemiennie

RU

Затягивайте попеременно

CZ

Pokręťta bagażníka dokręcaj naprzemiennie.

SK

Dofahujte striedavo

SLO

Privijajte izmenično.

HR

Naizmjenično zategnite

HU

Egymástól függetlenül szorítandó

GR

Σφιγγετε εναλάξ

TR

Dönüşümlü sıkın

中文

交替拧紧

한국어

변갈아 가며 조이십시오.

日本語

交互に締め付けてください。

ไทย

ขันในแบบสลับ

6

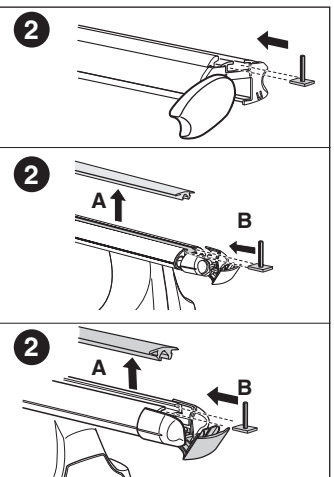
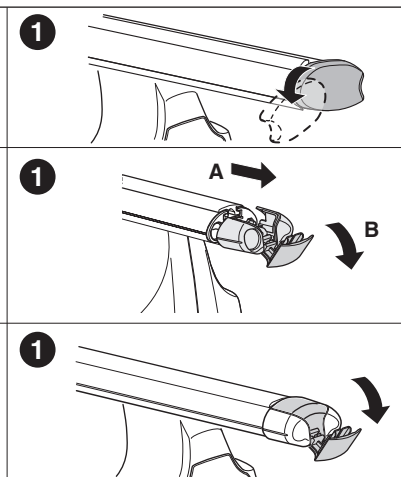
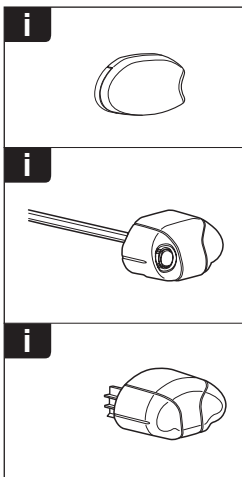
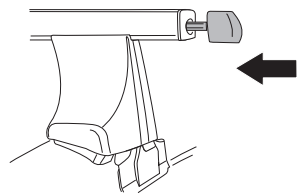
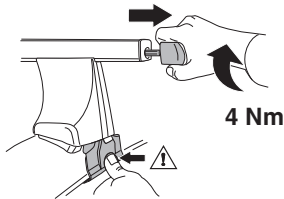
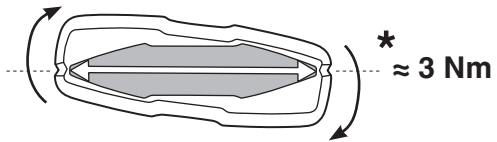
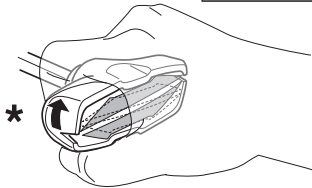
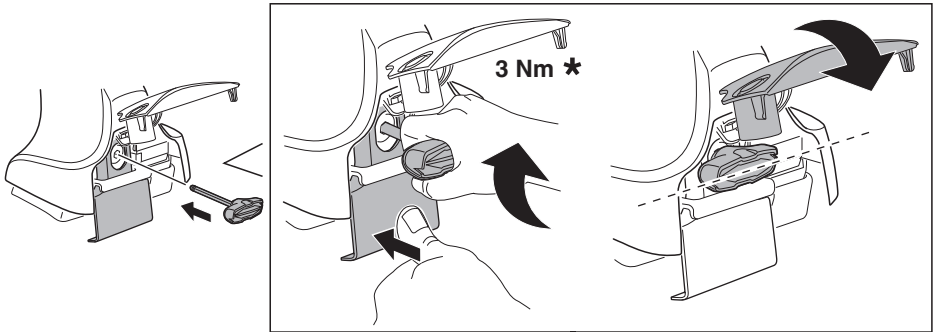
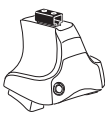

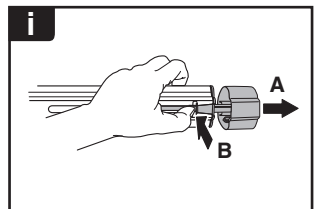
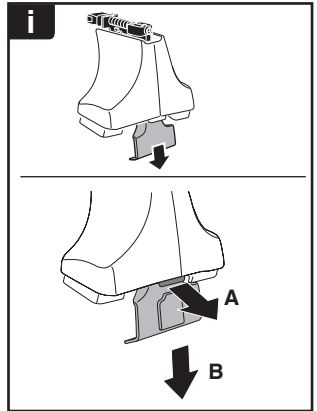
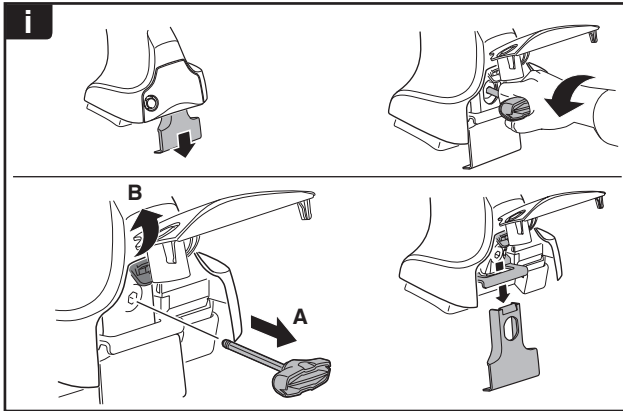
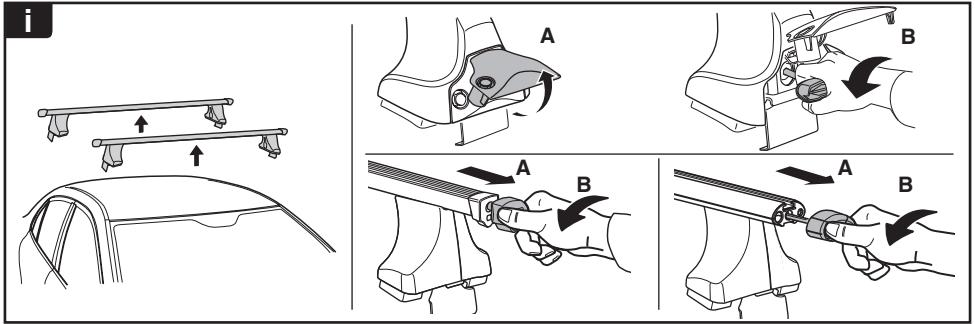

**THULE**  
SWEDEN  
**ONE  
KEY  
SYSTEM**



- 544 (x4)
- 596 (x6)
- 588 (x8)
- NA 510 (x10)
- EUR 452 (x12)
- ASIA

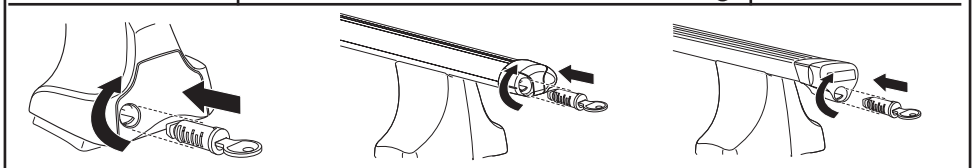

WW ▶ Thule Sweden AB, Box 69, 330 33 Hillerstorp, SWEDEN  
 NA ▶ Thule Inc., 42 Silvermine Road, Seymour, Connecticut 06483, USA

info@thule.com  
 customer.service@thule.com

www.thule.com