

Kit 1601

HYUNDAI ix 35, 5-dr SUV, 10-
HYUNDAI Tucson, 5-dr SUV, *10-

*North America

This Kit is only for vehicles without railing.

480R
754

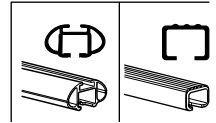
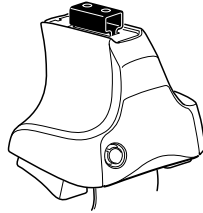

480

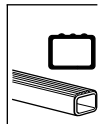
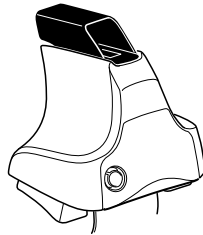

THULE[®]
SWEDEN

480R/754

480

Kit

1

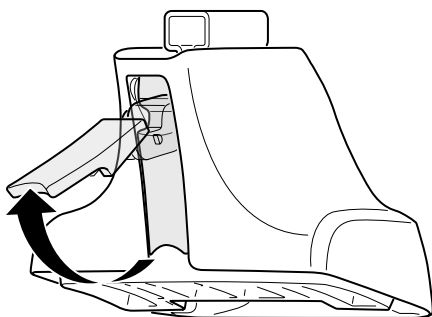
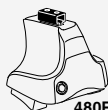

2

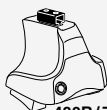

+

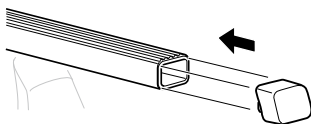
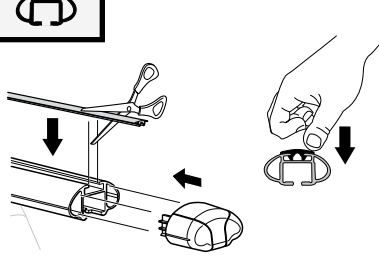
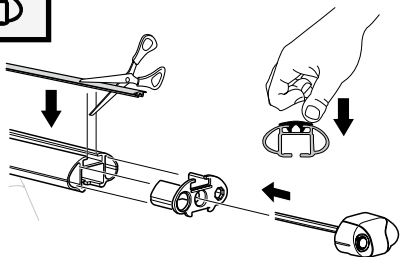
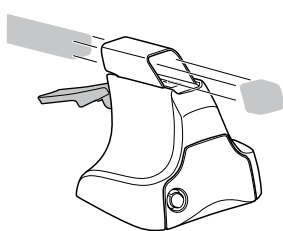
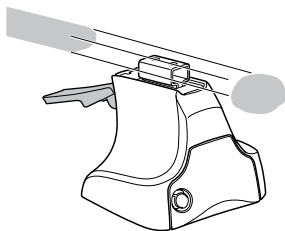

3



754

1

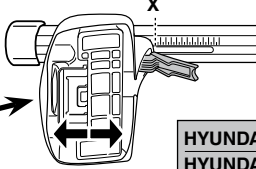
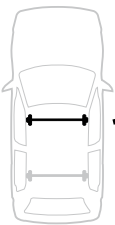

2

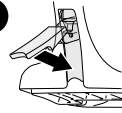

	X
HYUNDAI ix 35, 5-dr SUV, 10–	42,5
HYUNDAI Tucson, 5-dr SUV, *10–	42,5

1

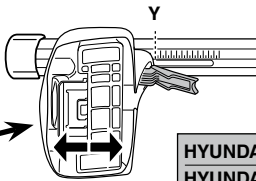

2

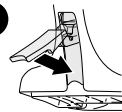

	Y
HYUNDAI ix 35, 5-dr SUV, 10–	39
HYUNDAI Tucson, 5-dr SUV, *10–	39

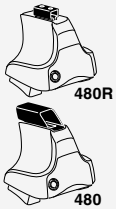

480R

480

1

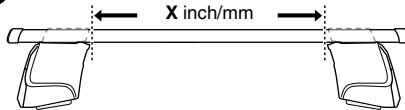

2

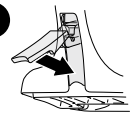

	X inch	X mm
HYUNDAI ix 35, 5-dr SUV, 10–	42 ³ / ₈ "	1076 mm
HYUNDAI Tucson, 5-dr SUV, *10–	42 ³ / ₈ "	1076 mm

1

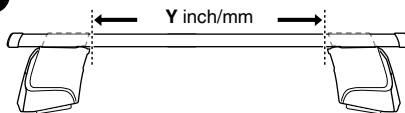

2

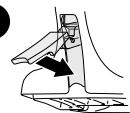

	Y inch	Y mm
HYUNDAI ix 35, 5-dr SUV, 10–	41 "	1041 mm
HYUNDAI Tucson, 5-dr SUV, *10–	41 "	1041 mm

4



480R/754



480

HYUNDAI ix 35, 5-dr SUV, 10-
HYUNDAI Tucson, 5-dr SUV, *10-

204



270



206

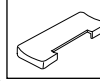

270



137



820



137

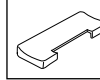

820

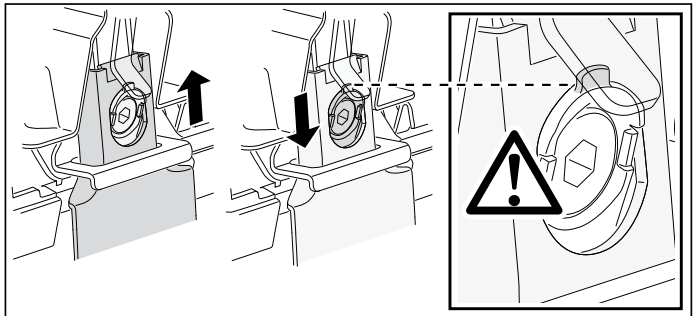
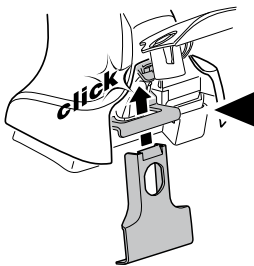
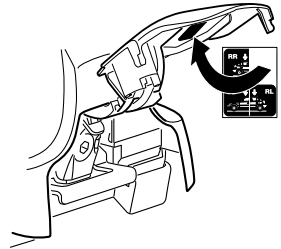
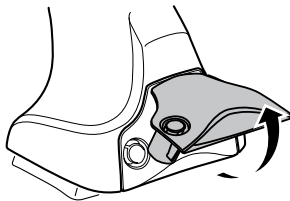
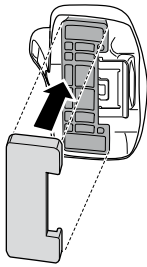

5



	X mm	Y mm	X inch	Y inch
HYUNDAI ix 35, 5-dr SUV, 10-	300 mm	620 mm	11 ³ / ₄ "	24 ³ / ₈ "
HYUNDAI Tucson, 5-dr SUV, *10-	300 mm	620 mm	11 ³ / ₄ "	24 ³ / ₈ "

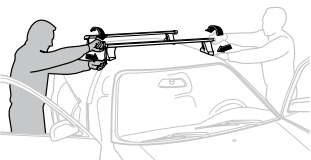
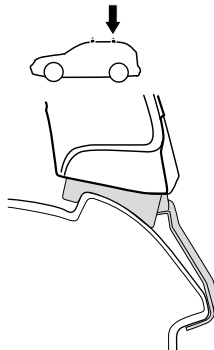
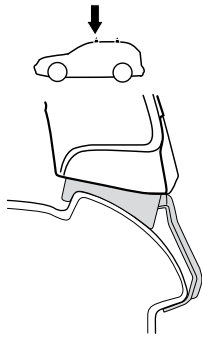
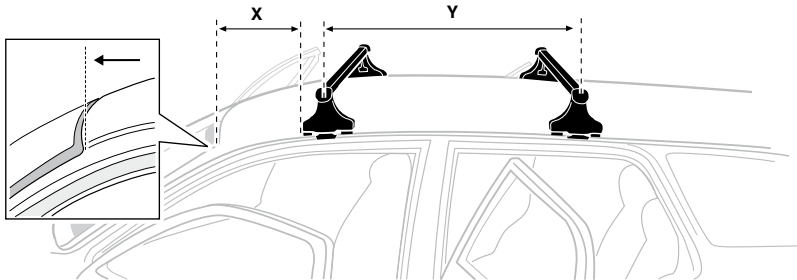

- | | | | |
|--------------|---|------------|---|
| GB/US | Tighten alternately | CZ | Pokreťta bagazníka dokrečaj dokrečaj naprzemiennie. |
| D | Die Schrauben abwechselnd anziehen | SK | Dofahajte striedavo |
| F | Serrer alternativement chaque côté | SLO | Privijajte izmenično. |
| NL | Afwisselend aan de linker- en de rechterkant aandraaien | HR | Naizmjenično zategnite |
| I | Alternare il serraggio delle viti | HU | Egymástól függetlenül szorítandó |
| E | Apretar alternativamente | GR | Σφιγγετε εναλλάξ |
| PT | Aperte alternadamente | TR | Dönüşümlü sıkın |
| S | Dra åt växelvis | 中文 | 交替拧紧 |
| FIN | Kierrä vuorotellen | 한국어 | 번갈아 가며 조이십시오. |
| EST | Pinguldage vaheldumisi | 日本語 | 交互に締め付けてください。 |
| LAT | Pievelciēt pamīšus | ไทย | ขันในแบบสลับ |
| LIT | Užsukinėkite pakaitomis | | |
| PL | Śruby dokrećaj naprzemiennie | | |
| RU | Затягивайте попеременно | | |

6

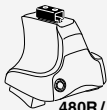

480R/754



480

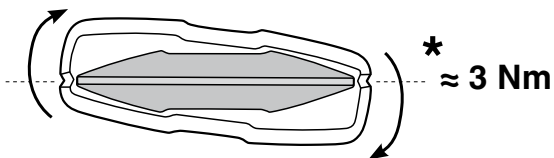
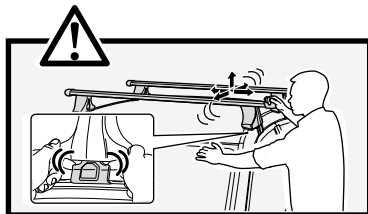
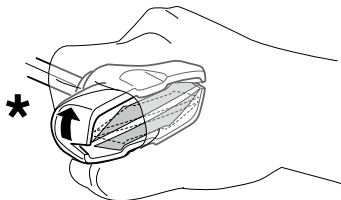
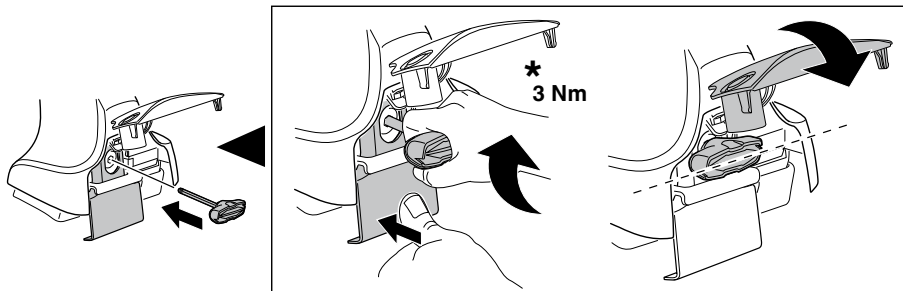

7

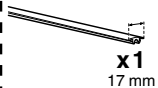

x1
17 mm

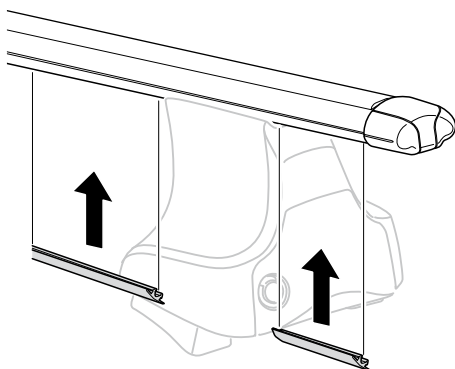

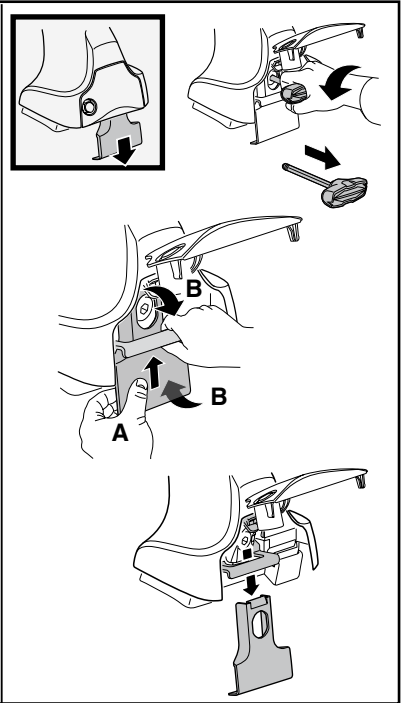
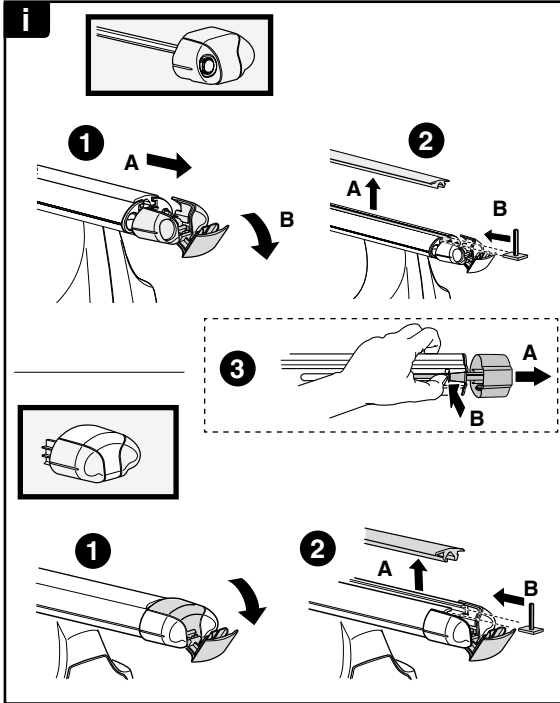

THULE
SWEDEN
**ONE
KEY
SYSTEM**

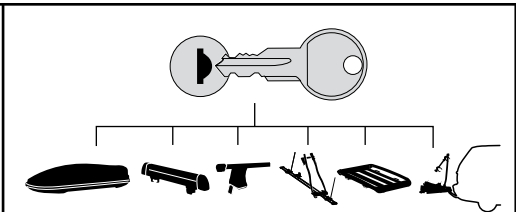

- 544 (x4)
 - 596 (x6)
 - 588 (x8)
 - 510 (x10)
 - 452 (x12)
- NA
EUR
ASIA



WW ▶ Thule Sweden AB, Box 69, 330 33 Hillerstorp, SWEDEN
NA ▶ Thule Inc., 42 Silvermine Road, Seymour, Connecticut 06483, USA

info@thule.com
customer.service@thule.com

www.thule.com