

# Kit 1603

HYUNDAI Santa Fe, 5-dr SUV, 10-

This Kit is only for vehicles without railing.

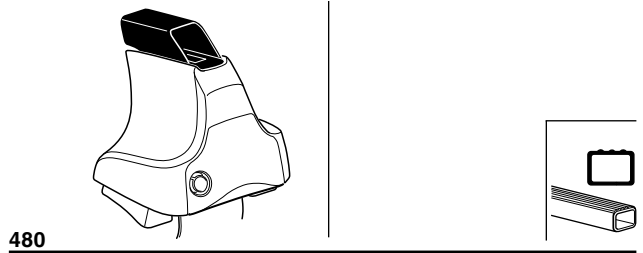
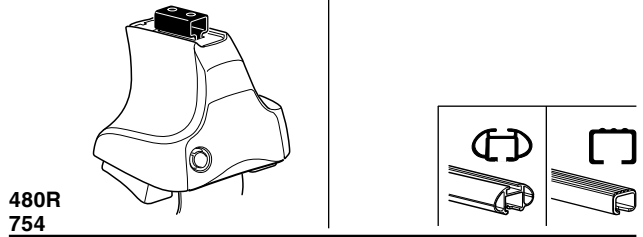

**Kit**

1

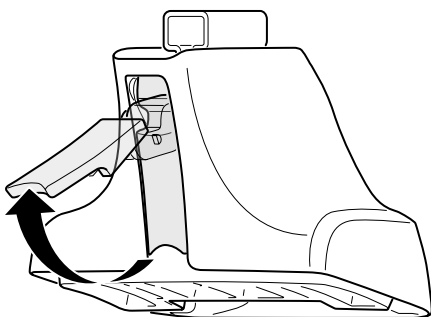
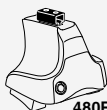

2



+

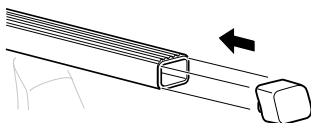
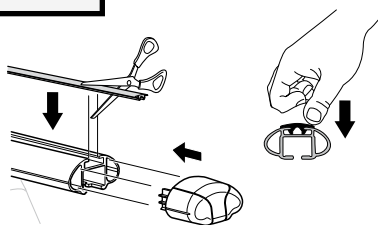
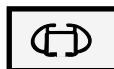
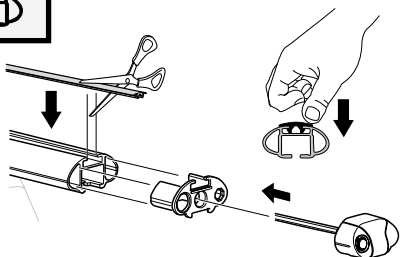
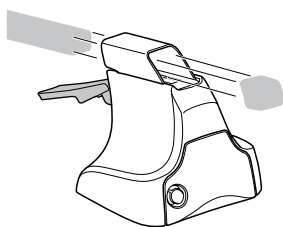
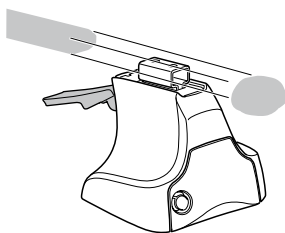

3

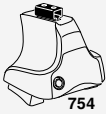

1

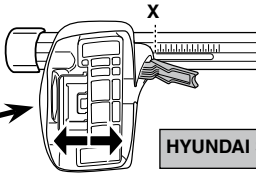
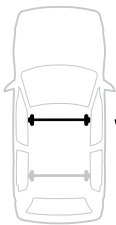

2

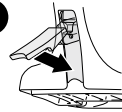

HYUNDAI Santa Fe, 5-dr SUV, 10-

X
45,5

1

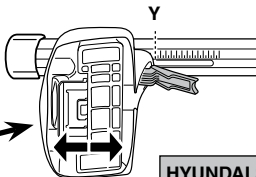

2

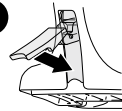

HYUNDAI Santa Fe, 5-dr SUV, 10-

Y
46

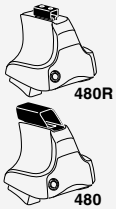

1

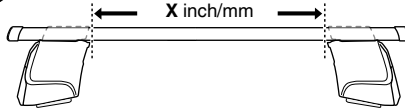
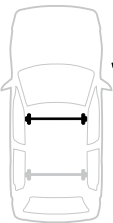

2

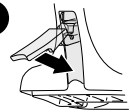

HYUNDAI Santa Fe, 5-dr SUV, 10-

X inch	X mm
43 1/2"	1106 mm

1

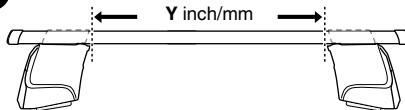

2

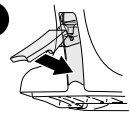

HYUNDAI Santa Fe, 5-dr SUV, 10-

Y inch	Y mm
43 3/4"	1111 mm

4

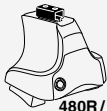

480R/754



480

HYUNDAI Santa Fe, 5-dr SUV, 10-

124



990



124



990



124



990



124



990

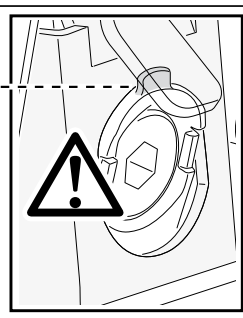
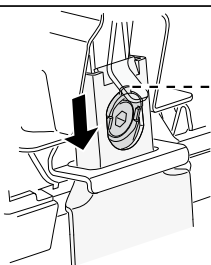
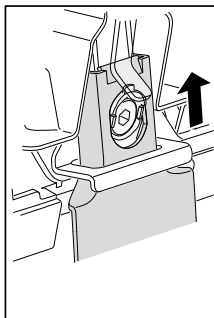
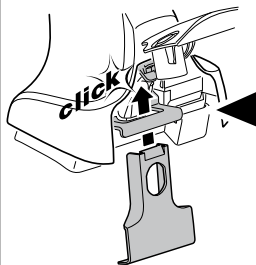
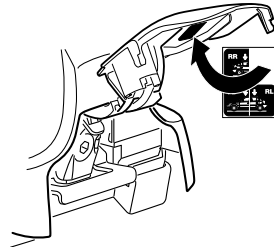
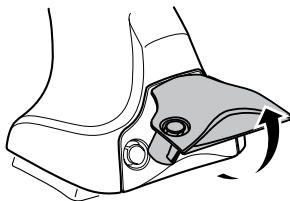
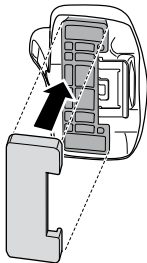
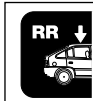

5



	X mm	Y mm	X inch	Y inch
<b>HYUNDAI Santa Fe, 5-dr SUV, 10-</b>	<b>340 mm</b>	<b>700 mm</b>	<b>13 3/8"</b>	<b>27 1/2"</b>

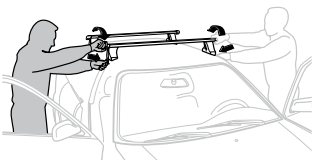
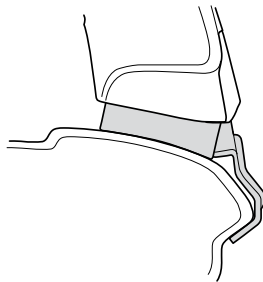
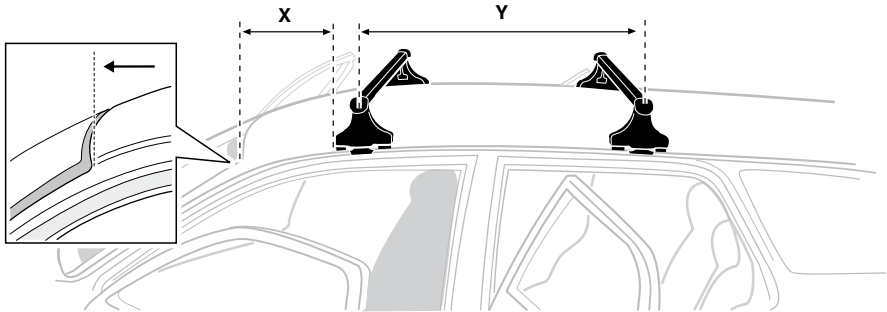

- |              |   |            |   |
|--------------|---|------------|---|
| <b>GB/US</b> | Tighten alternately                                     | <b>CZ</b>  | Pokreťta bagazníka dokrečaj dokrečaj naprzemiennie. |
| <b>D</b>     | Die Schrauben abwechselnd anziehen                      | <b>SK</b>  | Dofahujte striedavo                                 |
| <b>F</b>     | Serrer alternativement chaque côté                      | <b>SLO</b> | Privijajte izmenično.                               |
| <b>NL</b>    | Afwisselend aan de linker- en de rechterkant aandraaien | <b>HR</b>  | Naizmjenično zategnite                              |
| <b>I</b>     | Alternare il serraggio delle viti                       | <b>HU</b>  | Egymástól függetlenül szorítandó                    |
| <b>E</b>     | Apretar alternativamente                                | <b>GR</b>  | Σφιγγείτε εναλλάξ                                   |
| <b>PT</b>    | Aperte alternadamente                                   | <b>TR</b>  | Dönüşümlü sıkın                                     |
| <b>S</b>     | Dra åt växelvis   | <b>中文</b>  | 交替拧紧  |
| <b>FIN</b>   | Kierrä vuorotellen                                      | <b>한국어</b> | 번갈아 가며 조이십시오.                                       |
| <b>EST</b>   | Pinguldage vaheldumisi                                  | <b>日本語</b> | 交互に締め付けてください。                                       |
| <b>LAT</b>   | Pievēciēt pamāšus                                       | <b>ไทย</b> | ขันในแบบสลับ  |
| <b>LIT</b>   | Užsukinkite pakaitomis                                  |            |   |
| <b>PL</b>    | Śruby dokrečaj naprzemiennie                            |            |   |
| <b>RU</b>    | Затягивайте попеременно                                 |            |   |

6

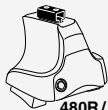

480R/754



480

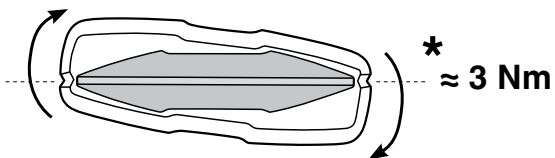
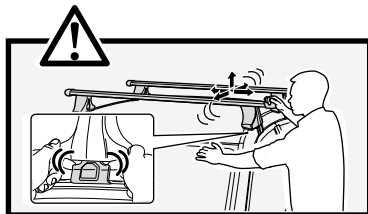
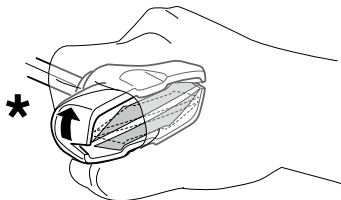
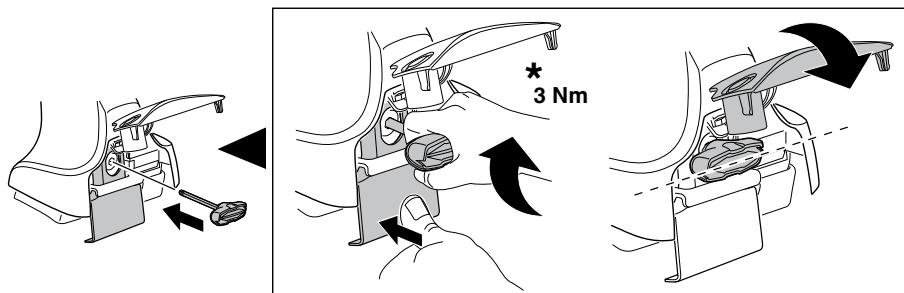

7

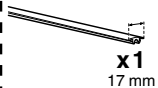

x1  
17 mm

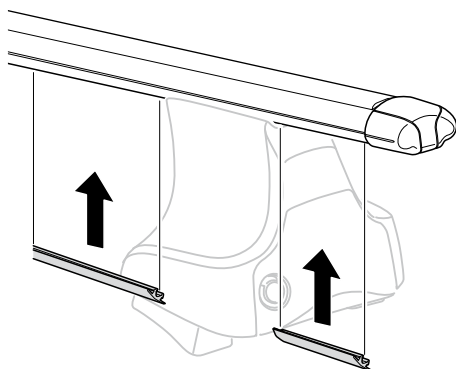

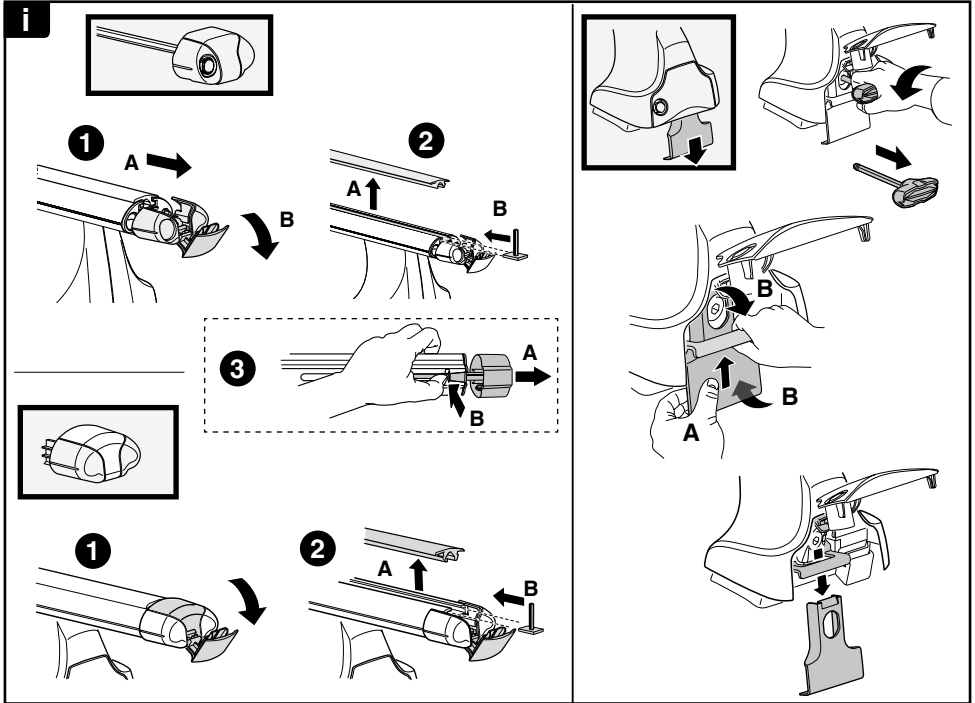

**THULE**  
SWEDEN  
**ONE  
KEY  
SYSTEM**

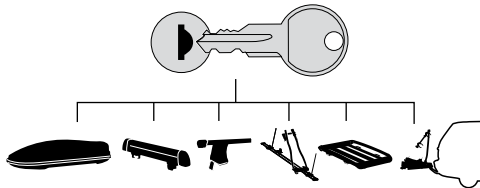

**544** (x4)  
**596** (x6)  
**588** (x8)  
**510** (x10)  
**452** (x12)

NA  
EUR  
ASIA

