

Kit 1611

FIAT 500, 3-dr Hatchback, 07-*

FIAT 500, 3-dr Hatchback, 11-**

*Without glass roof

**North America, Without glass roof

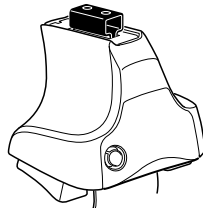

480R Rapid Traverse
754 Rapid System

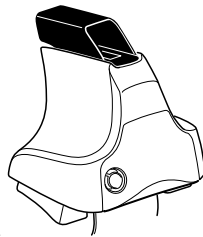
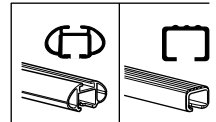

480 Traverse

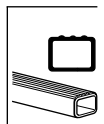

Max. 50 kg
Max. 110 lbs

Kit XXXX
 instructions

480R Rapid Traverse
754 Rapid System

480 Traverse

Kit

1

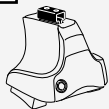

480R Rapid Traverse
754 Rapid System



480 Traverse

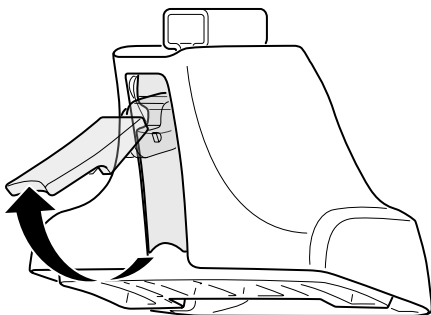

2

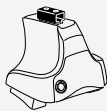

480R Rapid Traverse
754 Rapid System



480 Traverse

+

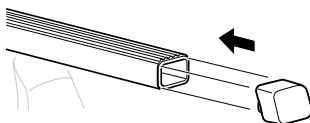
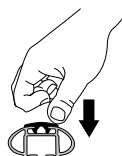
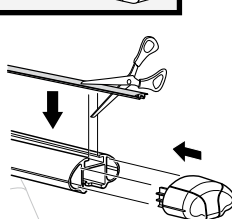
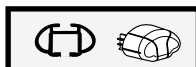
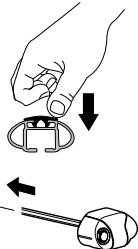
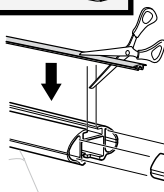
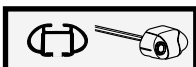
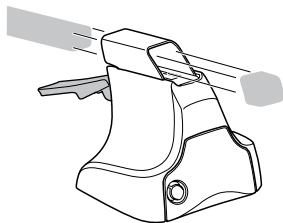
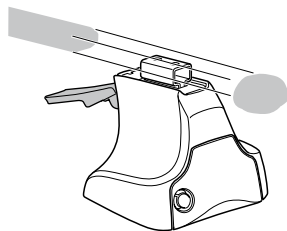

3

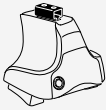

754 Rapid System

1

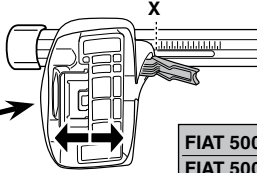
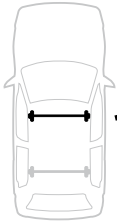

2

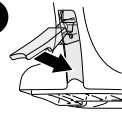

	X
FIAT 500, 3-dr Hatchback, 07-*	33,5
FIAT 500, 3-dr Hatchback, 11-**	33,5

1

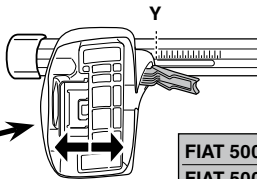
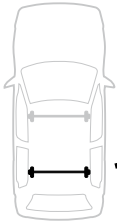

2

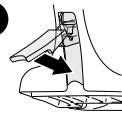

	Y
FIAT 500, 3-dr Hatchback, 07-*	28
FIAT 500, 3-dr Hatchback, 11-**	28



480R Rapid Traverse



480 Traverse

1

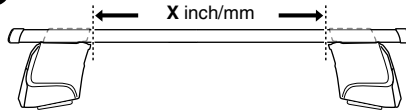

2

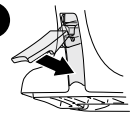

	X inch	X mm
FIAT 500, 3-dr Hatchback, 07-*	38 ⁷ / ₈ "	986 mm
FIAT 500, 3-dr Hatchback, 11-**	38 ⁷ / ₈ "	986 mm

1

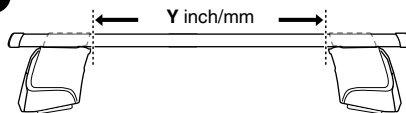

2

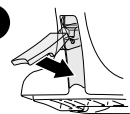

	Y inch	Y mm
FIAT 500, 3-dr Hatchback, 07-*	36 ⁵ / ₈ "	931 mm
FIAT 500, 3-dr Hatchback, 11-**	36 ⁵ / ₈ "	931 mm

4

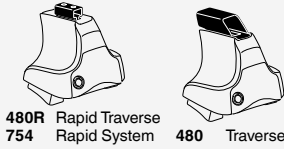

480R Rapid Traverse
754 Rapid System

480 Traverse

FIAT 500, 3-dr Hatchback, 07-*

FIAT 500, 3-dr Hatchback, 11-**

SRA

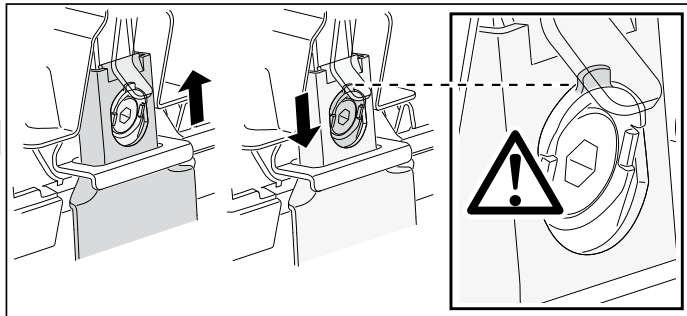
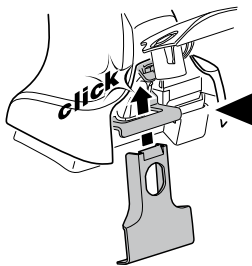
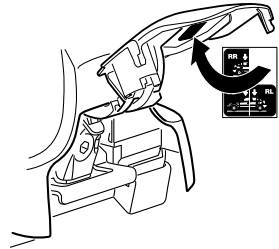
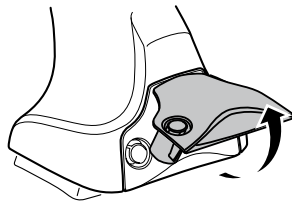
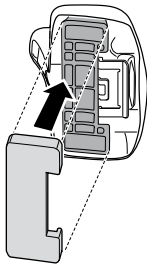
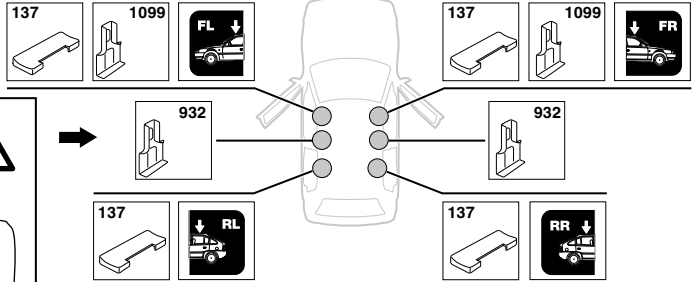
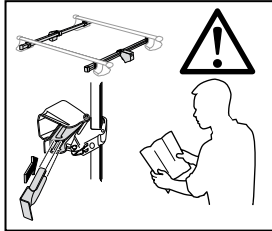

5



	X mm	Y mm	Z mm	X inch	Y inch	Z inch
FIAT 500, 3-dr Hatchback, 07-*	225 mm	600 mm	350 mm	8 7/8"	23 5/8"	13 3/4"
FIAT 500, 3-dr Hatchback, 11-**	225 mm	600 mm	350 mm	8 7/8"	23 5/8"	13 3/4"

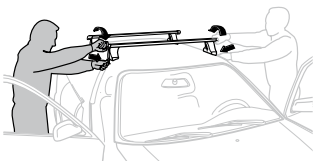
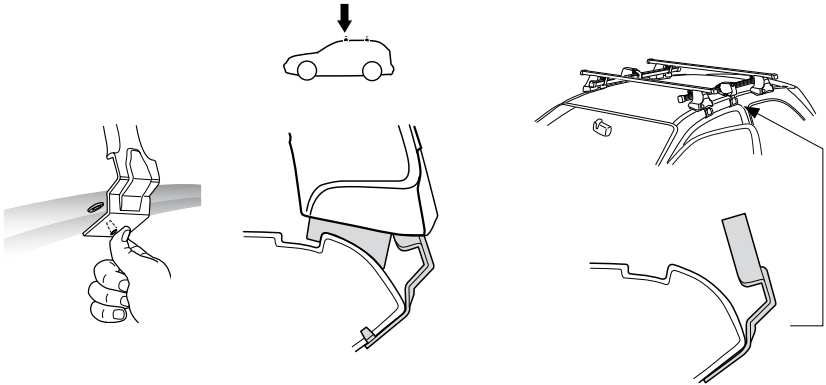
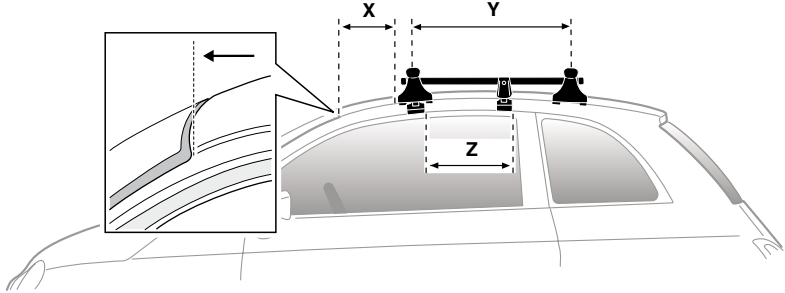

GB/US Tighten alternately

D Die Schrauben abwechselnd anziehen

F Serrer alternativement chaque côté

NL Afwisselend aan de linker- en de rechterkant aandraaien

I Alternare il serraggio delle viti

E Apretar alternativamente

PT Aperte alternadamente

S Dra åt växelvis

FIN Kierrä vuorotellen

EST Pinguldage vaheldumisi

LAT Pievelciēt pamīšus

LIT Užsukinėkite pakaitomis

PL Śrubby dokręcaj naprzemiennie

RU Затягивайте попеременно

CZ Pokrétla bagazníka dokręcaj dokręcaj naprzemiennie.

SK Dotahujte striedavo

SLO Privijajte izmenično.

HR Naizmjenično zategnite

HU Egymástól függetlenül szorítandó

GR Σφιγγετε εναλλάξ

TR Dönüşümlü sıkın

中文 交替拧紧

한국어 번갈아 가며 조이십시오.

日本語 交互に締め付けてください。

ไทย ชนในแบบสลับ

6

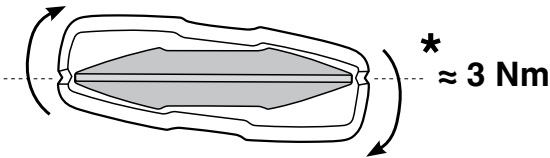
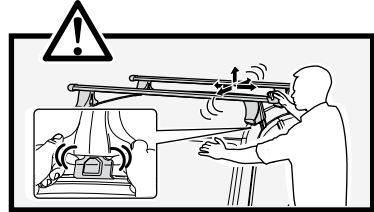
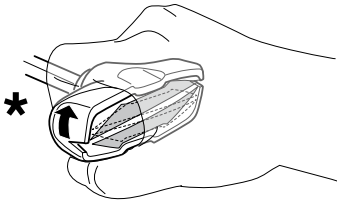
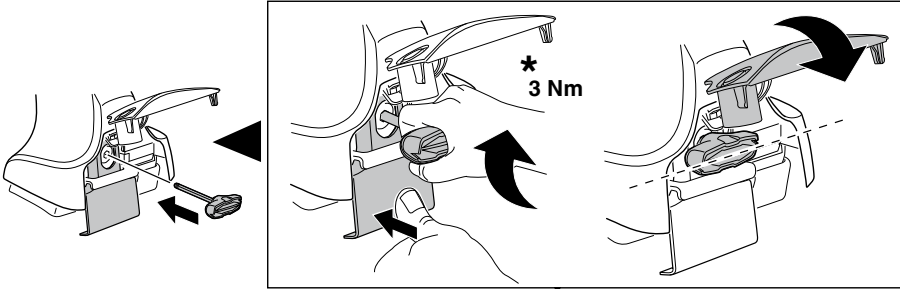
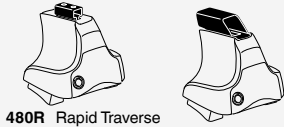

7

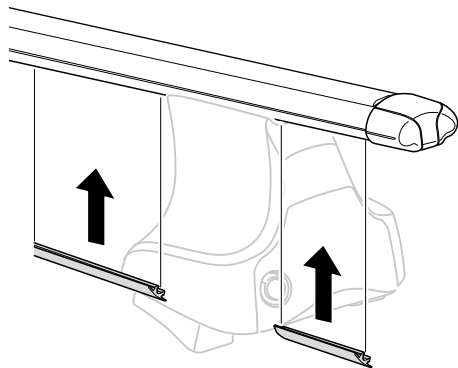
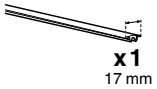

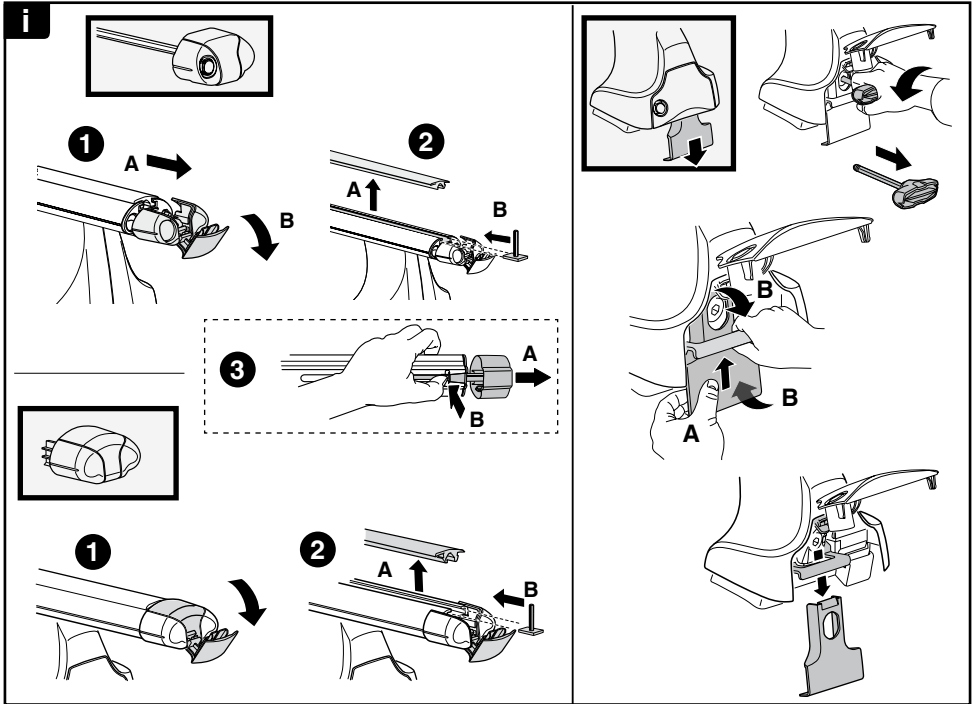
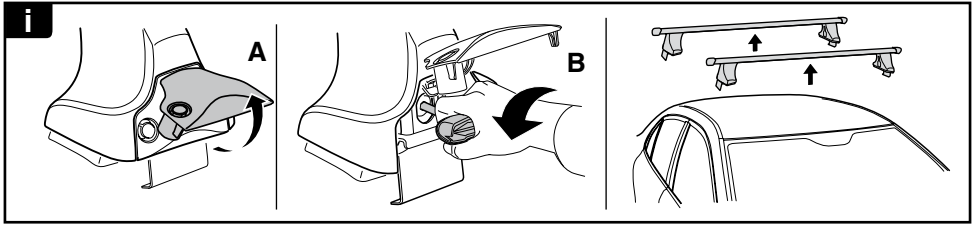

THULE
SWEDEN
**ONE
KEY
SYSTEM**

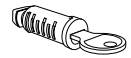
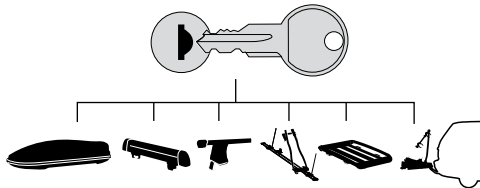

- 544** (x4)
- 596** (x6)
- 588** (x8)
- NA **510** (x10)
- EUR **452** (x12)
- ASIA

